

## PRODUCT DATASHEET LS/PD CI KIT

LS/PD CI KIT | Mounting kits



---

### Areas of application

- Offices
- Classrooms
- Conference rooms
- Corridors
- Stairways

---

### Product benefits

- Simple ceiling recessed mounting

---

### Product features

- Ceiling installation adapter
- Adapter ring and spring holder made of metal

TECHNICAL DATA

Dimensions & Weight

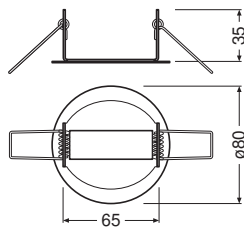

Height	36.0 mm
Diameter	80,0 mm
Product weight	76.00 g

Capabilities

Type of installation	Ceiling integration
----------------------	---------------------

Certificates & Standards

Approval marks – approval	CE
---------------------------	----

EQUIPMENT / ACCESSORIES

– Suitable for DALIeco LS/PD LI, DALI LS/PD LI and LS/PD LI Analog sensors

LOGISTICAL DATA

Product code	Packaging unit (Pieces/Unit)	Dimensions (length x width x height)	Gross weight	Volume
4052899920293	BAG 1	240 mm x 160 mm x 4 mm	80.00 g	0.15 dm <sup>3</sup>
4052899920422	Shipping box 10	190 mm x 164 mm x 184 mm	902.00 g	5.73 dm <sup>3</sup>

The mentioned product code describes the smallest quantity unit which can be ordered. One shipping unit can contain one or more single products. When placing an order, for the quantity please enter single or multiples of a shipping unit.

DISCLAIMER

Subject to change without notice. Errors and omission excepted. Always make sure to use the most recent release.